



Refrigerator

Instruction manual

Model:

**2040 010**

**2040 020**

**2040 030**

**EN**

## **INDEX**

### **Important safety and environmental warnings**

- 3 SAFETY INFORMATION
- 4 SCRAPPING OF OLD APPLIANCES
- 5 Compliance
- 5 Energy saving
- 6 Before first use

### **Use and maintenance**

- 6 Using the Refrigerator
- 7 Cool Zone Drawer
- 7 Using the Freezer
- 8 Storage
- 9 Control Panel
- 12 LED Light Replacement Instructions
- 13 Care and Cleaning; Defrosting
- 14 Troubleshooting

### **Installation**

- 16 Installation preparation
- 17 Ventilation
- 18 Technical diagrams
- 21 Installation instructions
- 22 Door leaf installation
- 24 Reversing the door

### **Important safety and environmental warnings**

Before using your refrigerator, please read this instruction manual carefully to maximize its performance. Keep all documentation for later use or for other owners. This product is intended for household use only or similar applications such as:

The kitchen area for staff in shops, offices and other work environments, on farms, by customers in hotels, motels and other residential type environments, in bed and breakfast (B&B) establishments, for food service and similar non-retail applications.

This appliance is intended for food preservation only; any other use is considered dangerous and the manufacturer will not be responsible for any omissions. It is also advisable to take note of the warranty conditions.

### **SAFETY INFORMATION**



Warning; Risk of fire / flammable materials This appliance is not intended for use by persons (including children) with reduced physical, sensory or mental capabilities, or lack of experience and knowledge, unless they have been given supervision or instruction concerning use of the appliance by a person responsible for their safety.

Children should be supervised to ensure that they do not play with the appliance.

If the power cord is damaged, it must be replaced by the manufacturer, its service agent or similarly qualified persons in order to avoid a hazard.

**WARNING:** Keep ventilation openings in the appliance cabinet or built-in structure free from obstruction.

**WARNING: Do not use mechanical devices or other means to accelerate the defrosting process, other than those recommended by the manufacturer.**

**WARNING: Do not damage the refrigerant circuit.**

**WARNING: Do not use electrical appliances inside the food storage compartments of the appliance unless they are of the type recommended by the manufacturer.**

**WARNING: When positioning the appliance, ensure that the power cord is not trapped or damaged.**

**WARNING: Do not place multiple portable power outlets or portable power supplies on the back of the appliance.**

Do not store explosive substances such as aerosol cans with a flammable propellant in this appliance.

This appliance is intended for use in household and similar applications such as:

- staff kitchen areas in shops, offices and other work environments.
- agricultural businesses and customers of hotels, motels and other residential-type environments.
- bed and breakfast type environments.
- catering and similar non-commercial uses.

Please comply with local regulations regarding the disposal of the appliance due to its flammable refrigerant and combustion gas.

If the LED light is damaged, it must be replaced by the manufacturer, its service agent or similarly qualified persons in order to avoid a hazard.

**WARNING: To avoid a hazard due to the instability of the appliance, it must be fixed in accordance with the instructions**

#### **SCRAPPING OF OLD APPLIANCES**



This appliance is marked in accordance with the European Directive 2012/19/EU on Waste Electrical and Electronic Equipment (WEEE).

WEEE contains both pollutants (which can cause negative consequences for the environment) and basic components (which can be reused). It is important to subject WEEE to specific treatments, in order to remove and dispose of all pollutants correctly and to recover and recycle all materials.

Individuals can play an important role in ensuring that WEEE does not become an environmental issue; it is essential to follow some basic rules:

- WEEE must not be treated as household waste;
- WEEE must be delivered to the relevant collection points managed by the municipality or registered companies. In many countries, for large WEEE, there may be home collection.

In many countries, when you buy a new appliance, the old one can be returned to the retailer who must take it back free of charge on an individual basis, provided that the appliance is of an equivalent type and has the same functions as the appliance supplied.

#### Compliance

By placing the mark  on this product, we confirm compliance with all applicable European safety, health and environmental requirements in legislation for this product.

#### Energy saving

For better energy saving we suggest:

Install the appliance away from heat sources and not exposed to direct sunlight and in a well-ventilated environment.

- Avoid placing hot foods in the refrigerator to avoid increasing the internal temperature and thus causing continuous operation of the compressor.
- Do not introduce excess food, so as to ensure proper air circulation.
- Defrost the appliance if ice is present to facilitate the transfer of cold.
- In the event of a power failure, it is advisable to keep the refrigerator door closed.
- Open or keep the appliance doors open as little as possible
- Avoid adjusting the setting to temperatures that are too cold.
- Remove dust from the back of the appliance

### **Before first use**

Before turning on the refrigerator, it is necessary to let it settle for at least four hours.

It is recommended to clean the inside of the appliance before first use, using a solution of baking soda and hot water and drying the inside thoroughly. The refrigerator may have a bad smell when first used. This will disappear as the appliance cools down.

### **Please note:**

The appliance starts at 5°C for the refrigerator and -18°C for the freezer and runs continuously until the correct temperature is reached. If the appliance is turned off, you must wait five minutes before turning it on again to avoid unnecessary damage to the compressor. Never store flammable or explosive objects and strong corrosive acids or alkalis in the appliance. This refrigerator refrigerates food by cooling the inner rear part of the cavity. It is normal for frost to accumulate on this surface; it then disperses and flows through a small drain at the bottom, where it evaporates harmlessly. Frost at the back does not indicate a malfunction of the refrigerator.

## **USE AND MAINTENANCE**

### **Using the refrigerator**

- Never put uncovered liquids in the refrigerator.
- Never put hot food in the refrigerator. Hot food should be allowed to cool to room temperature before being refrigerated.
- Nothing should rest against the back wall of the refrigerator, as this will cause frost and possible condensation problems that will be difficult to remove.

Make sure the food is clean and excess water is removed before placing it in the refrigerator.

Wrap or cover food before placing it in the refrigerator. This will help prevent moisture loss, keep food fresh, and avoid unpleasant odors.

Sort food items before storing them. Any food items that are to be used soon should be stored at the front of the shelf to avoid spoilage caused by opening.

extended door.

- Do not overfill the refrigerator. There should be enough space between foods to allow cold air to circulate.
- Defrosting frozen foods in the refrigerator compartment will help keep the temperature low and save energy.

Never store raw meats on shelves above cooked meats or other products.

- This will help prevent raw meat juices from contaminating other foods.

### **Cool Zone Drawer**

The temperature inside the Cool Zone drawer can be adjusted from +3°C to – 3°C. This is the ideal drawer for storing meat and fish.

Using the freezer

The freezer compartments are designed to store frozen foods only.

- Never put hot or warm foods in the freezer, let them cool completely before placing them inside.
- Follow the instructions on the food packaging for storing frozen foods. If no information is provided, foods should not be stored for more than three months after the date of purchase.
- Store food in small packages (ideally less than 1 kg). This reduces the freezing time and improves the quality of the food after defrosting.
- Wrap food before placing it in the freezer. To prevent the wrap from sticking, make sure it is dry.
- Label food before freezing with information including the type of food and the best-before and best-before dates.
- Once thawed, food should not be refrozen. Defrost only the amount of food needed to avoid waste.
- Bottled or canned drinks should not be stored in freezer compartments as they may explode.
- Do not attempt to freeze more than the maximum amount.

## Conservation

The refrigerator section is for short-term storage of food. Although it is possible to maintain low temperatures, prolonged periods of food storage are not recommended. As cold air circulates inside the refrigerator, the temperature may vary between different sections. Therefore, food should be stored in different sections depending on the type.

1. Butter, cheeses etc.
2. Food in jars and bottles
3. Beverages, e.g. milk
4. Cooked foods
5. Yogurt, conserve ecc.
6. 75 cl portions or ready meals etc.
7. Fruits and vegetables
8. Fresh meat and fish/fruit and vegetables (Cool Zone)

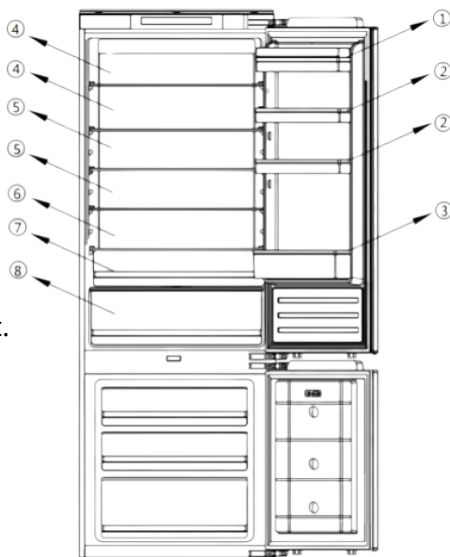

The refrigerator shelves can be moved according to the storage needs within the refrigerator section. To move the shelf, lift the second rear one and then pull it out.

To replace, slide the shelf into the slot, then lower the rear section.

More energy saving configurations require drawers, food container and shelves to be placed in the product, please refer to the images above.



## Control Panel



**1.** When you turn on the appliance for the first time, it always uses the settings: 5°C for refrigerator, 0°C for Cool Zone and -18°C for freezer. If you want to adjust the temperature or functions manually, press the button to perform the operations. Cool Zone temperature ranges from -3°C to 3°C.

**2.** Adjusting the refrigerator temperature: Press button 4 on the left side of the control panel to obtain different temperatures from 2°C to 8°C.

**3.** Freezer temperature adjustment: Press button 5 on the right side of the control panel to obtain different temperatures from -15°C to -25°C.

**4.** Cool Zone Drawer Adjustment Function: Button 1 controls the temperature of the Cool Zone drawer. By pressing this button, the figure will change from -3° to +3°. This function can be activated/deactivated by continuously pressing for three seconds (shows OFF).

**5.** Rapid cooling function: Press button 2 to activate the rapid cooling function, the refrigerator starts working automatically with the set temperature of 2°C and switches off after 24 hours. Press again to deactivate. During automatic operation the button is backlit and switches off automatically after the time has elapsed.

**6.** Vacation function: Press button 3 to activate the vacation function. The entire appliance starts to operate automatically with the following settings: refrigerator at 17° C and freezer at -18° C. The button remains backlit.

Press again to deactivate.

**7. Eco function:** Press button 6 on the control panel, the eco function is activated and the button lights up, the refrigerator compartment operates at 5° C and the freezer compartment at -18° C. The Cool Zone area operates at a setting of 3° C. Pressing button 6 again to deactivate, the temperature settings are maintained.

**8. Quick freeze function:** Press button 7, the button light lights up and the freezer starts working with quick freeze function, temperature setting -25°C. After 24 hours, the quick freeze function automatically stops.

**9. Power On/Off:** Press the 8 button for 3 seconds to turn off the appliance, and when the button lights up, the power is cut off. The internal lights go out, the compressor stops working. Press the button for 3 seconds to turn on the appliance, the symbol lights up and the power is connected again.

**10. Defrost:** On no-frost models, the manual defrost function is available to clean the freezer evaporator. Press the 5+8 buttons (freezer area) for 5 seconds to activate the defrost function and the freezer temperature digits will light up. Press the 5+8 button for 3 seconds to deactivate the defrost function. The freezer temperature digits will go out.

### **Alarm display**

This appliance has the "alarm display" function. If the sensors fail, alarms will be displayed on the temperature display, the appliance will continue to refrigerate but you need to call a professional technician to check the same.

F2 – Cool zone sensor

F3 – Refrigerator sensor

F4 – Freezer sensor F5 – Defrost sensor  
2E – Faulty fan or motor in freezer  
CE – Error between control panel and display

**The above errors are only displayed on the display without alarm.**

Freezer overtemperature alarm: If the temperature rises to  $> -1^{\circ}\text{C}$ , the audible alarm will start, accompanied by the freezer temperature digit flashing.

Press any button to cancel the voice alarm. The flashing will continue until the temperature is  $<-1^{\circ}\text{C}$ .

NOTE: The main board is located in the compressor compartment

POSITION	CONDITIONS
5°C / -18°C	Summer or room temperature between 25°C-35°C
5°C / -18°C	Spring or room temperature between 15°C-25°C
5°C / -18°C	Winter or room temperature between 5°C-15°C
Quick freeze function	quick freezing
Quick cooling function	rapid cooling

## LED light replacement instructions

Note: LED lights are not user replaceable, need to be replaced by professionals.

Lighting parameters: 12V

1. Unplug the power plug.
  2. Remove the aluminum alloy trim strip on the top of the LED surface light source, then remove the fixing screws on the left and right.
- Steps 1 and 2 are shown below.
3. Replace the LED light.
  4. Replace the aluminum alloy trim strip.

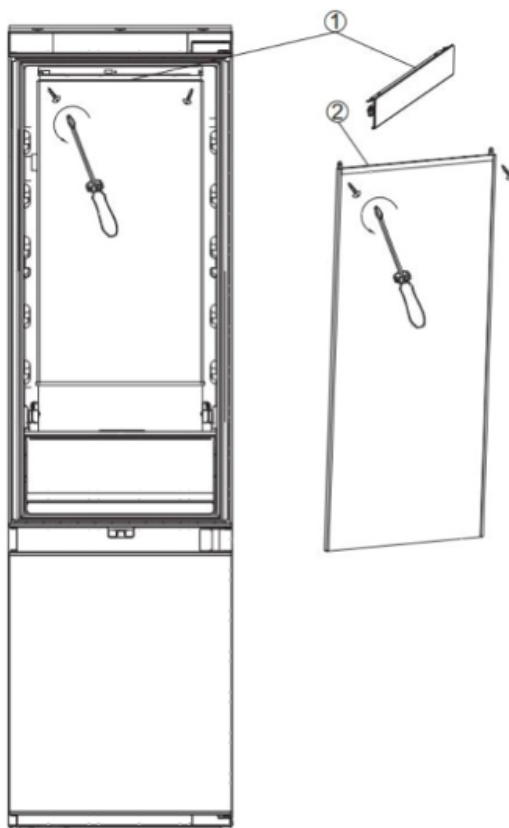

## Care and cleaning

Always disconnect the appliance from the electrical supply before any cleaning or maintenance.

The refrigerator and freezer sections should be cleaned using a solution of baking soda and warm water. Do not use abrasive products or detergents.

After washing, rinse and dry thoroughly.

Clean the shelves and balconies separately by hand with a mild solution of detergent and water. Do not put them in the dishwasher.

If the appliance is not to be used for a long period of time, unplug it and clean it. The doors should be slightly ajar to prevent the formation of mold and unpleasant odors.

## Defrosting

The product has a no frost system which is designed to prevent heavy ice build-up.

Under normal use, it should not be necessary to defrost your freezer regularly.

**Please note:** If ice or water regularly builds up in the freezer section, the door may not be sealing properly. This could be due to a faulty door seal or the refrigerator door panel not being properly installed or excessively heavy.

For more information, see the Ice Buildup Troubleshooting section.

## Troubleshooting

If you have a problem with your appliance, there are a few things you should check before calling customer service.

### **If the appliance does not work, check that:**

- the appliance is powered.
- The house fuses are intact and the fuse in the plug is not blown.
- The refrigerator has not been turned off.
- The power outlet is working properly (check if another electrical appliance is connected to the same outlet)

### **If the appliance works, but not properly, check that:**

- The appliance is not overloaded.
- The thermostat is set to an appropriate temperature.
- The doors close properly.
- The cooling system at the rear of the appliance is clean and free of dust and does not touch the rear wall.
- There should be sufficient ventilation on the side and rear walls.

### **If the appliance is noisy, check that:**

- The appliance is level and stable.
- The side and rear walls are clear and nothing is resting on the appliance.
- **Note:** The refrigerator's cooling gas may make a slight gurgling sound, even when the compressor is not running.

### **If the appliance beeps, check:**

- That the doors are closed. The alarm will sound 60 seconds after a door is opened.

### **If ice has formed on the back wall of the refrigerator:**

- It is normal for some frozen droplets to form on the back wall of the refrigerator. This does not indicate a fault with the appliance.
- Make sure that no refrigerator element is in contact with the rear wall.

- Check that there is some resistance when opening the appliance door. If it opens at the slightest touch, the door seal may need to be replaced.
- Check the door seal for twists, debris, or damage. If you notice a problem and cannot resolve it yourself, contact Customer Service to have the seal replaced.
- This may be because the decorative doors are not properly secured. If in doubt, ask your technician to check the decorative doors.

**If excess ice has formed in the freezer:**

- Check that there is some resistance when opening the appliance door. If it opens at the slightest touch, the door seal may need to be replaced.
- Check the door seal for twists, debris, or damage. If you notice a problem and cannot resolve it yourself, contact Customer Service to have the seal replaced.
- This may be because the decorative doors are not properly secured. If in doubt, ask your technician to check the decorative doors.

**If one or more LED units inside the appliance do not work:**

- Contact Customer Service to arrange a technical intervention.

## Preparing for installation

**This appliance should never be installed near heat sources such as radiators or cooking zones, or in damp places.**

**Ask for the help of another person or two when installing this appliance. This appliance may have sharp edges. Wear PPE appropriate for the job and environment.**

To ensure that the appliance is level, you must use the height-adjustable feet on the front of the appliance.

The cooling system on the back of the appliance should not touch the back wall. The best solution is to leave a large space. The appliance should be installed with adequate ventilation.

Make sure there is free space above the appliance to allow air to escape and that there is space between the back of the appliance and the wall.

Do not tilt more than 40°

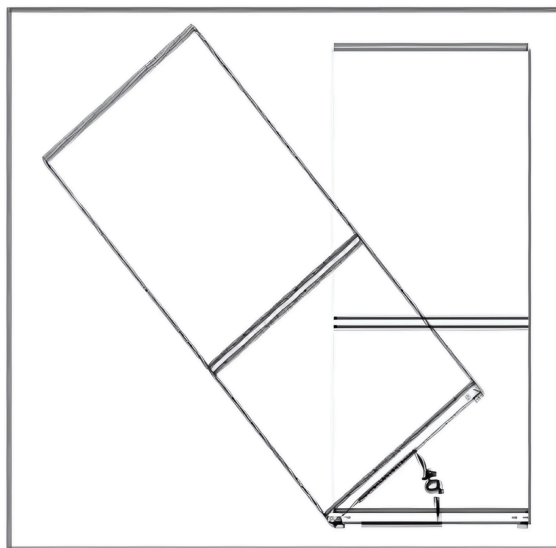



## Ventilation

The primary consideration when installing any refrigeration unit in a fixed kitchen is ventilation. Heat removed from the cooling compartment must be dissipated into the atmosphere. Improper ventilation can lead to premature compressor failure, excessive energy consumption, total system failure and may void the warranty provided with the appliance. For products intended to be installed in a high rise living unit, the following requirements must be met:

- To allow air to enter freely, it is necessary to provide an air intake somewhere in the furniture.

In this example, a plinth vent is located under the refrigerator. You will need to cut an opening in the plinth under the refrigerator/freezer and carefully finish it with the vent grille.

A: refrigerator profile

B: min. 30mm gap C:

top view

Alternatively, a thin section of the plinth can be removed to allow air to enter the unit (500mm x 40mm recommended) The top of the cabinet should have a vent into the room. Recommended vent size: 500mm x 40mm. If the cabinetry does not allow free air to enter the room, a plinth or other means of ventilation should be provided to ensure a natural flow of air.

There must be a space at the back of the cabinet to allow cold air to be directed onto the condenser.

Recommended: 500 x 40 mm

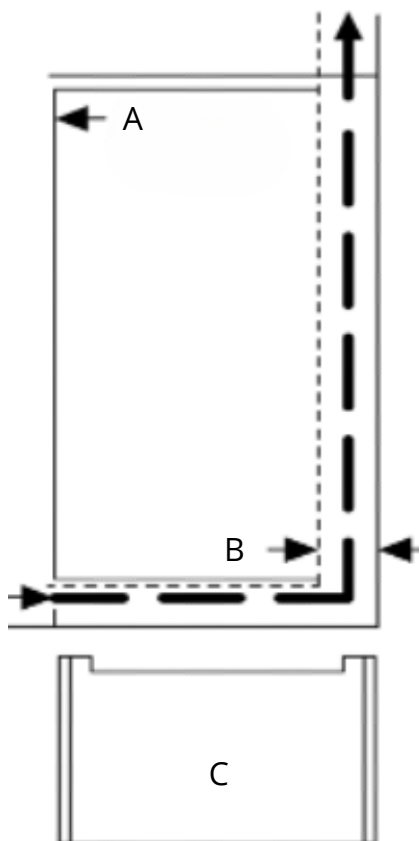

For the appliance to function properly, it is important that the top of the unit is not obstructed. **As a rule, the more air that can enter and exit, the better and more efficient the product will function.**

### Technical/built-in diagrams

Model 2040 010

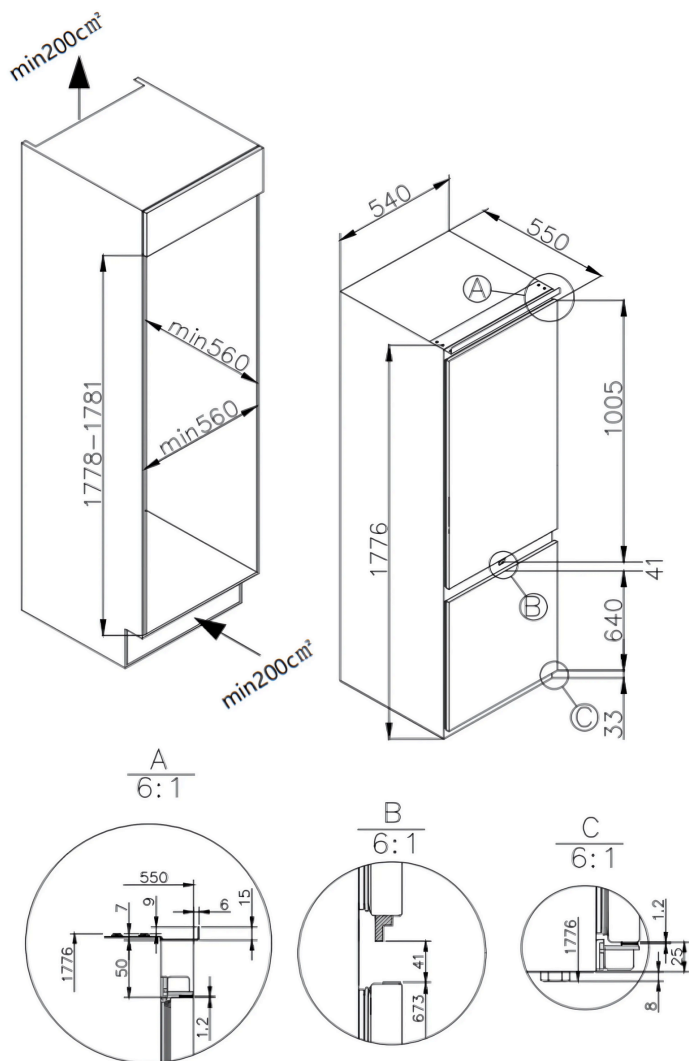

# Model 2040 020

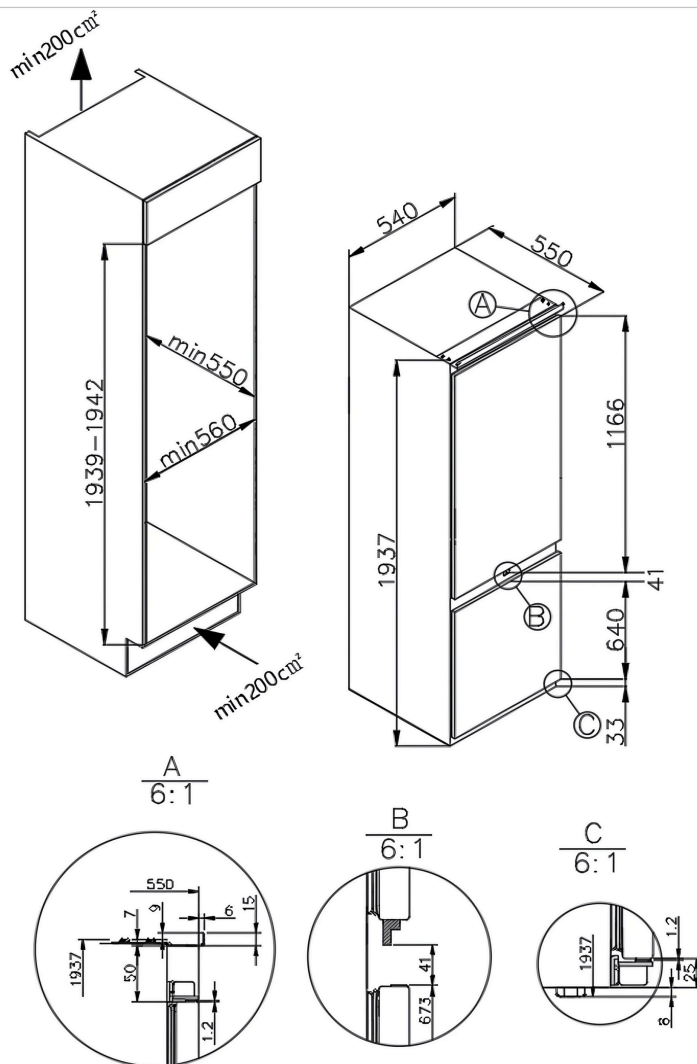

# Model 2040 030

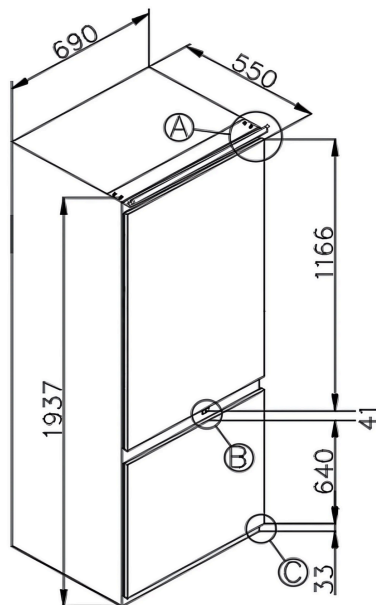
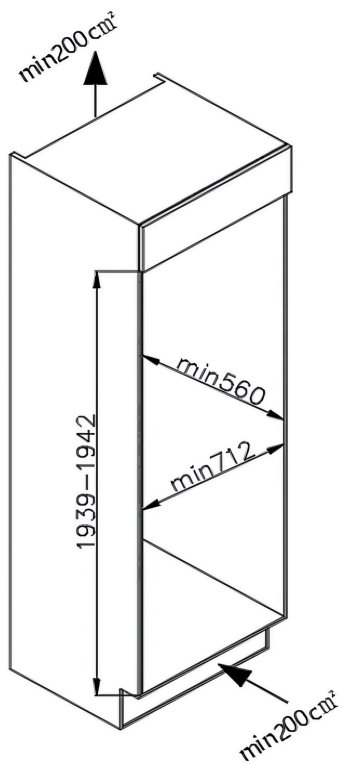

A  
6:1

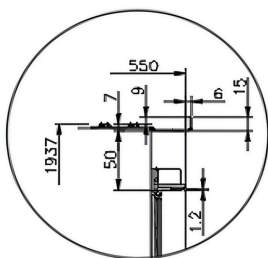

B  
6:1

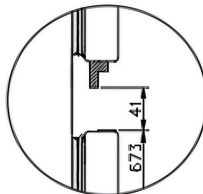

C  
6:1

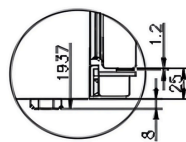

## Installation instructions (sliding hinge model)

It is recommended that the installation operation be carried out with more than one person.

Place the refrigerator inside the cabinet for which it is intended. The refrigerator at the base is equipped with metal plates, use the white spacers provided and fix them to these.

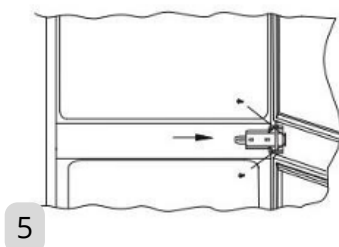
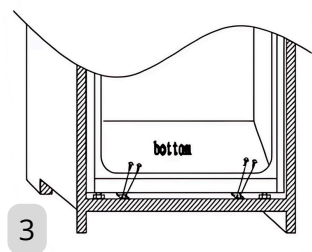
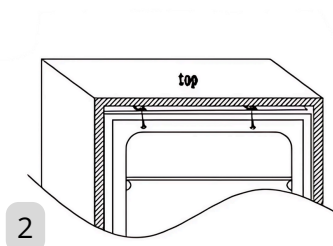
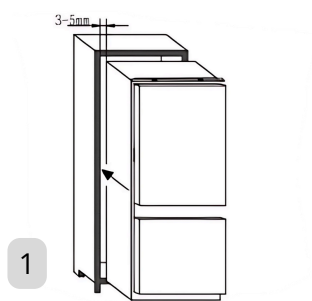

1. Place the refrigerator inside the cabinet, leaving a space of 3-5 mm between the wall of the appliance and the wall of the cabinet, on the side opposite the hinges.
2. After making sure that the position of the refrigerator and cabinet hinges matches, attach the plastic cover found in the accessories bag supplied with the appliance.
3. Fix the refrigerator to the lower part of the cabinet with screws.
4. Apply the gasket between the refrigerator and the cabinet wall (door opening side), cut off the excess gasket. Apply the plastic covers to the lower part of the cabinet (bracket fixing)
5. Using a cross-head screwdriver, you can loosen the pin, located under the central hinge, and adjust it to fix it correctly to the door of the built-in cabinet.

### Door leaf installation

- Make sure there is a gap of 3-5 mm between the refrigerator and the cabinet wall (side without hinges)
- Place the slide guide inside the sliding support and then position and fix it approximately 20-22 mm from the edge of the cladding panel.
- Tighten the screws firmly by hand.



- Complete the installation by applying the gasket between the refrigerator and the cabinet on the door opening side.

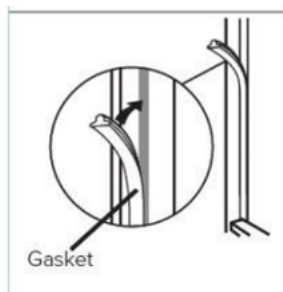

- Make sure the door opens and closes properly
- Once the installation is complete, you can fold and detach the excess plastic part (dotted part S) from the bracket cover

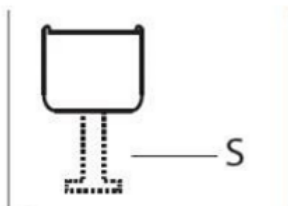

Once installation is complete, check that the closed door shows a minimum resistance when opening (a sign of correct adhesion of the door seal).

If the door opens too smoothly (without resistance), it is likely that the appliance and the cabinet covering panel have not been installed correctly.

## Reverse the door (change the opening direction)

The user is advised to seek the support of other people to carry out this operation.

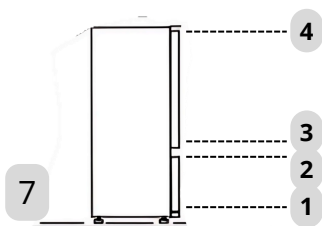
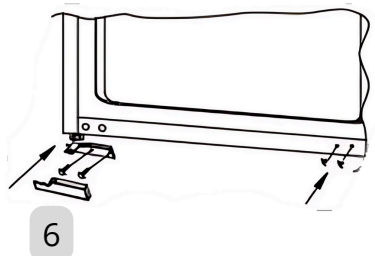
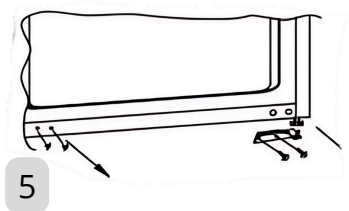
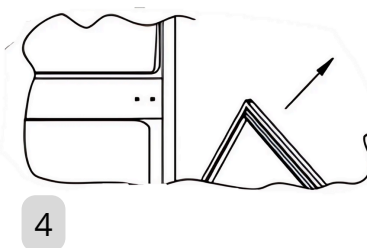
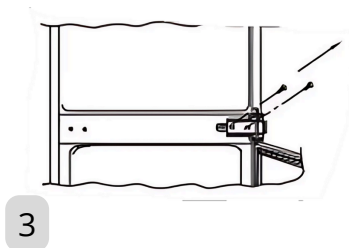
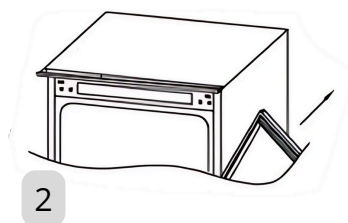
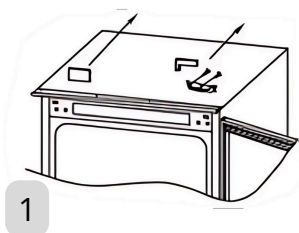



1. At the top of the refrigerator remove the hinge hole cover and unscrew the hinge.

**Warning:** Hold the door still as it may fall!

2. Remove the refrigerator door by pushing it slightly upwards.

3. Remove the central hinge by unscrewing it.

**Warning:** Hold the freezer door steady as it may fall!

4. Remove the freezer door by lifting it slightly and pulling it out of the lower hinge seat.

5. Remove the lower hinge by unscrewing it and remove the plastic cover.

6. Install and screw the top right hinge into the holes on the bottom left of the refrigerator.

7. Reassemble the doors proceeding from bottom to top, fixing them from point 1 (bottom) to point 4 (top).

### **Make sure the door closes properly**

It is normal for the seal to be compressed after the door has been inverted. With the door closed, use a hair dryer to expand the seal and fill the gap between the door and the body of the appliance. Be careful not to use the hair dryer too close to the appliance, which could damage the seal. A distance of about 10 cm should be adequate. After you have finished, allow the seal and door to cool before touching them. The seal should remain in place once you have finished.

## Product Support

This manual provides the main features of the product.

For further technical information or assistance, please contact your dealer or authorized technical assistance center.

Information is available on the website [www.fosterspa.com](http://www.fosterspa.com)



### IMPORTANT

Before contacting the retailer or technical assistance centre, it is advisable to take note of the model and serial number of the appliance, as well as any error messages shown on the display.

The code, model and serial number are available on the product data plate located inside the refrigerator (side wall, drawer area).





Foster s.p.a  
via M.S. Ottone 18/20 , 42041 Brescello (RE) , Italy  
[www.fosterspa.com](http://www.fosterspa.com)  
[info@fosterspa.com](mailto:info@fosterspa.com)