

## Cooker hob GK

Gas hobs

Code: 7626 032



### DETAILS

Edge/Installation Type	Flat Edge
Finish	Foster brushed
Material	AISI 304 stainless steel
Texture	Brushed in line
Supply	220-240 V; 50/60 Hz
Dimensions	1050x470 mm
Base size	120cm
Heating element	Four burners
Cut out	1030x450 mm

Grids	Cast iron grids and enamelled burner covers
-------	---

Width	105 cm
-------	--------

Total power	9.500 W
-------------	---------

Auxiliary	1.000 W
-----------	---------

Semirapid	2x1.750 W
-----------	-----------

Dual	5.000 W
------	---------

Safety	Safety valve with quick-acting thermocouple
--------	---

Ignition	Electric ignition under knob
----------	------------------------------

Gas type	Tested for installation with natural gas, LPG nozzle set included.
----------	--

Type	Gas Hob
------	---------

## FEATURES

Gas hobs	
----------	--

Under-knob ignition	The utmost freedom of movement with electronic under-knob ignition, a common feature of all models that allows a one-hand ignition of the burner.
---------------------	---

Aeo burners	The AEO burners guarantee up to 25% energy saving compared to standard burners. All models are designed with The Dual burner with 2 independent crowns, controlled by a single knob, delivers from 1 to 5KW, a power that can only be found in professional models.
-------------	---

## Special burners

Many Foster hobs are equipped with special burners, with two or three rings of fire that greatly increase the power delivered and the heated surface. In the DUAL models the two fire crowns also have independent ignition, making these burners perfect for both intensive and delicate cooking.

---

## Safe cooking

All Foster cooker hobs are equipped with safety valves. They shut off the gas supply very quickly if the flame accidentally goes out.

---

## Cast iron grids

Cast-iron is the ideal material for an hob grid, this due to the manifold properties characterising it: high heat capacity that improves cooking performance; high weight and stability that improve safety; sturdiness that preserves the hob's original aspect over time; easy cleaning.

---

## Inclined recess

A deep and inclined recess houses the burners and grids, allowing to create a single work surface. The inclination also makes it extremely easy to clean the edges.

---

## Ultra-flat hob

Design meets functionality in the the ultra-flat models. Elegant grids that form a generously sized overall surface.

---

## TECHNICAL DATA

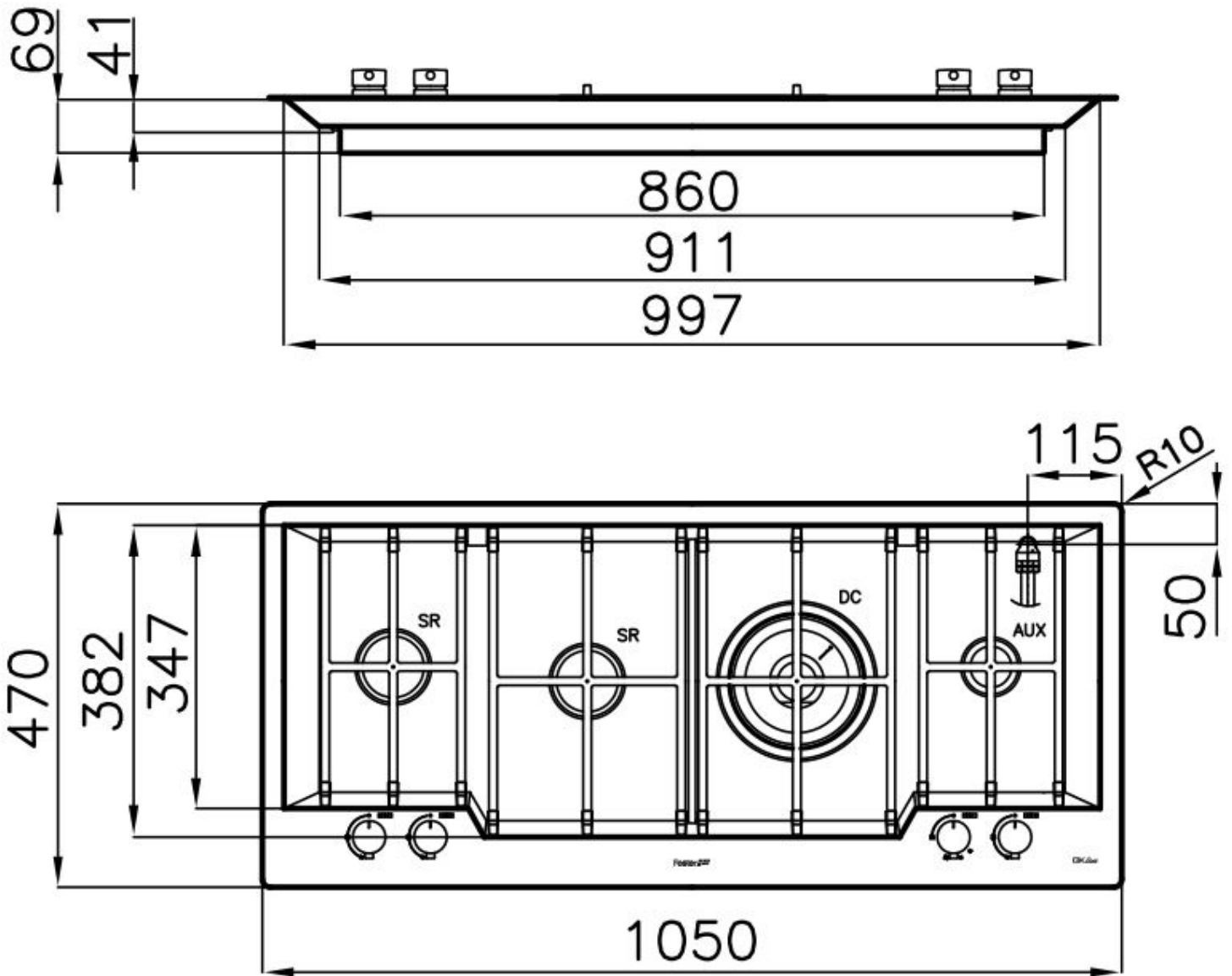

## OPTIONAL ACCESSORIES



**Cast iron wok support**  
9601 727



**Induction Pro - Cookware set - 8pcs**  
8210 008