

Cooker hob - Quadra Modular Induction Plate

Induction Hobs

Code: 7366 350

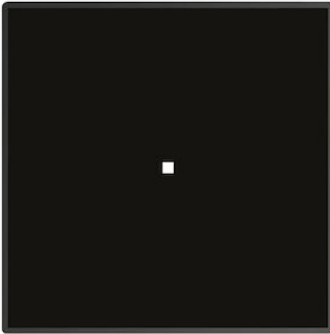

DETAILS

Coloring Black

Edge/Installation Type Bevelled Edge - for flush-mount or over-mount installation

Material Ceramic glass

Supply Single-phase: 230 V; 1P + N; Two-phase 400 V; 2P + N; 50.60 Hz

Dimensions 350x350 mm

Full description Induction Plate 350 x 350 mm - for Quadra Modular System

Heating element single zone

Total power 2.300 (3.000)* W

Power settings 9 power settings per zone + Powerboost

Safety

Safety equipment

Type

Induction Hob

Type of commands

Touch Control

Notes:

* Powerboost

Notes:

TECHNICAL DATA

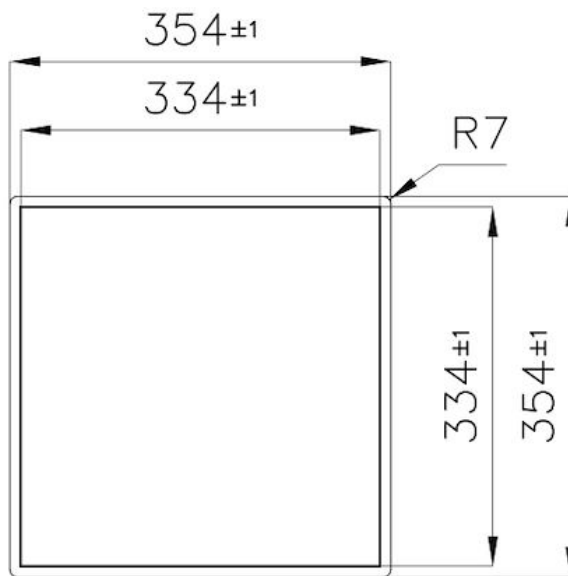
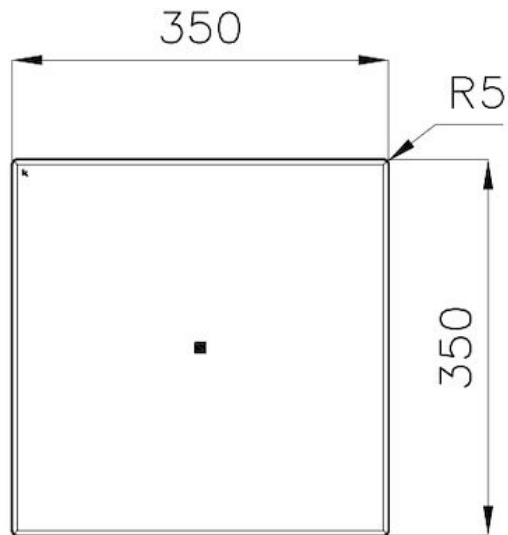
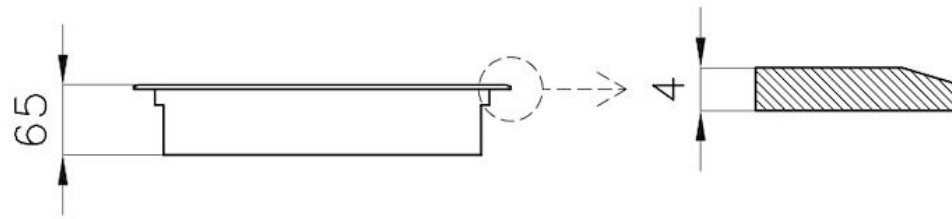

GALLERY

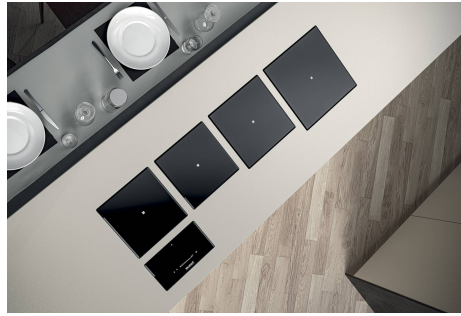

RECOMMENDED PAIRINGS



**Cooker hob Touch Control Modular
Quadra**
7367 040



**Cooker hob Touch Control Modular
Quadra**
7367 030



**Cooker hob Touch Control Modular
Quadra**
7367 020



**Modular Induction - Connection
Box**
7369 040



**Modular Induction - Connection
Box**
7369 030



**Modular Induction - Connection
Box**
7369 020